

Flow Controller with vortex baffle or, without flow indicators, with one or two glasses, up to 280 °C

Technical Data

Connection	DA 2.00 : G 3/8 -1 DA 4.00 : DN 15 - 250
Nominal Pressure	PN 16 - 40
Glasses	DA 2.00 has single glass DA 4.00 has 2 glasses

Description

Flow sightglasses with vortex baffle or without flow indicator may be used for easy checking of fill levels, consistency, bi- or multi-phase flows or condensate. They may also be used for mixtures of liquids, gases and vapours.

DA 2.00 is fitted with one glass and one vortex baffle which induces turbulence in the fluid and thus makes it easier to see the flow.

DA 4.00 is a flow sightglass with two glasses without internal components. A good view of the fluid is provided by the two opposite glasses.

For flow sightglasses with flow indicators see data sheets DA 1.10/2.1.061.1, DA 3.10/2.1.061.1 and DA 6.00/2.1.061.1

STANDARD EQUIPMENT

- Soda lime glasses

OPTIONS

- Various seal materials suitable for your medium
- Rubber or plastic coating for corrosive media
- Borosilicate glasses
- Halogen sightglass light
- High pressure models up to PN 160
- Special versions on request

Operating instructions, Know How and Safety instructions must be observed.

The pressure has always been indicated as overpressure.

We reserve the right to alter technical specifications without notice.

DA 2.00

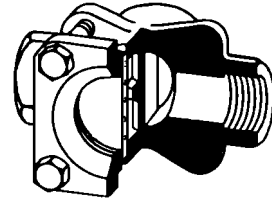

DA 4.00

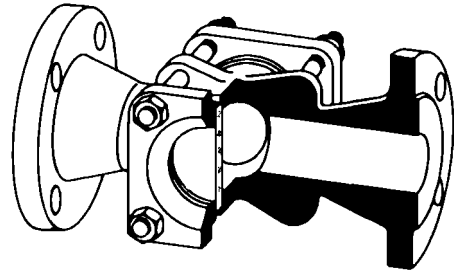

Flow Controller with vortex baffle or, without flow indicators, with one or two glasses, up to 280 °C

Materials		
Temperature	150 °C	280 °C
Body	PN 16	up to DN 25 grey cast iron from DN 32 spheroidal cast iron optional: DN 80 - 200 St 37-2
	PN 25/40	G 3/8 - 2, DN 15 - 65: C 22.8 DN 80 - 200: St 37-2
	PN 16 - 40	CrNiMo-steel
Seal	Nova Universal	Graphit
Glasses	soda lime glasses	maxos glasses
Screws	5.6 zincd	5.6 zincd

Dimensions [mm] DA 2.00							
size	nominal pressure	nominal diameter G					
		3/8	1/2	3/4	1	1 1/4	1 1/2
A	PN 16 (cast iron)	100		135	145	155	165
	PN 16 (CrNiMo-St)	90					110
	PN 40	90					110
B	PN 16 (cast iron)	50		60	70	90	
	PN 40, PN 16*	70				90	
C	PN 16 (cast iron)	75		85	110	140	
	PN 40, PN 16*	110				140	
D	PN 16 (cast iron)	□ 72		□ 85	□ 110		
	PN 40, PN 16*	ø115				ø 150	
E	PN 16 (cast iron)	ø 40		ø 50	ø 60	ø 66	
	PN 40, PN 16*	ø 50				ø 66	

* also for PN 16 CrNiMo-steel

Dimensions [mm] DA 4.00, BSPT female							
size	nominal pressure	nominal diameter G					
		3/8	1/2	3/4	1	1 1/4	1 1/2*
A	PN 16 (cast iron)	105		110	115	-	165
	PN 16 (CrNiMo-St)	90					110
	PN 40	90					110
B	PN 16 - 40	140					180
D	PN 16 (cast iron)	□ 85					□ 110
	PN 40, PN 16**	ø115					ø 150
E	PN 16 - 40	ø50					ø 66

* PN 16 grey cast iron not available ** also for PN 16 CrNiMo-steel

Dimensions [mm] DA 4.00, flange connection														
size	nominal pressure	nominal diameter DN												
		15	20	25	32	40	50	65	80	100	125	150	200**	250**
A	PN 16 (cast iron)	140	150	160	180	200	230	200	260	300	350	400	600	650
	PN 16 (CrNiMo-St) ***	164	168	168	172	178	202	290	on request					
	PN 40 (Steel)***	166	170	170	174	180	206	290	on request					
	PN 40 (CrNiMo-St)***	164	168	168	172	178	206	290	on request					
B	PN 16 - 40	140					180	220	250	270	460	500		
D	PN 16 (cast iron)	□ 85					□ 110	□ 120	□ 130	ø 190	ø 210	ø 285		
	PN 40, PN 16*	ø 115					ø 150	ø 150	on request					
E	PN 16 - 40	ø 50					ø 66	ø 80	ø 100	ø 110	ø 175			

* also for PN 16 CrNiMo-steel

** DN 200 and 250 made of St37-2

*** tolerance ± 2 mm

Weights [kg]																					
Type	nominal pressure	nominal diameter G						nominal diameter DN													
		3/8	1/2	3/4	1	1 1/4	1 1/2	2	15	20	25	32	40	50	65	80	100	125	150	200	250
2.00	PN 16	1.2	1.3	1.8	2.3	3.5	5.6														
	PN 40	4.5						9.0													
4.00	PN 16	2.6	2.8	3.0	3.2	3.5	6.5	3.5	4.0	5.0	6.0	7	10	13	17	26	36	43	80	126	
	PN 40	4.5						10	6.0	7.0	7.5	8.5	9	15	15	on request					

Special designs on request.

The pressure has always been indicated as overpressure.

Mankenberg reserves the right, to alter or improve the designs or specifications of the products described herein without notice.

**WIR REGELN DAS SCHON
FIRMLY IN CONTROL**

MANKENBERG

DA 2.00 sleeve

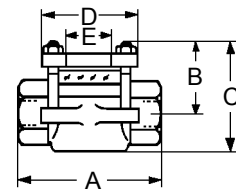

DA 4.00 sleeve

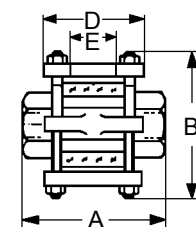

DA 4.00 flange

